



# Town of Rye Newsletter



Vol. 23, No. 3

A Publication of the Rye, New Hampshire, Select Board

December 2020

## Selectmen's Message:

### Parsonage Exchange, Tax Rate, Town Hall on National Register...

**Parsonage/TD Bank Building Exchange:** On November 9, 2020, the Select Board approved an amended contract between the Town and Dan Philbrick relating to the exchange of 500 Washington Road for 575 Washington Road. This agreement transfers the .04 acre Parsonage property to Dan Philbrick in exchange for the TD Bank building and 3.71 acres of land. An incentive for the amended contract includes a no build zone for the first 75 ft of the lot (approximately 40% of the property where structures currently exist), adjacent to the Library, as open space on which he will construct and maintain a landscaped garden area. The no build area will provide a large view corridor to the Library from traffic on Washington Road and ensure that no buildings ever block the view of the Library. An additional 3 foot easement for the benefit of the Library abutting the sidewalk from Washington Road to Old Parish Road in the amended contract will facilitate access by the Library for snow removal and for maintenances of the sidewalks. To satisfy zoning requirements for the Philbrick building, the Town is allocating three parking spaces on the north end of the parking lot, currently shared by the Library and the Town Museum, abutting what will be the Philbrick property for use by the tenants of his property. In return the Library will receive four dedicated parking spaces adjacent to the north side of the Town Hall for use of the Library staff.

Mr. Philbrick will build five apartments on the north end of the Parsonage lot with one planned for use as his office. (the original warrant article allowed for eight apartments in a renovated Parsonage Building, however, Mr. Philbrick found the building in such a state of disrepair that he could not cost effectively rehabilitate the building). In support of this decision, in 2019, the Town hired a Historic Preservation Consultant who reported that the Parsonage building had undergone too many alterations in the 20<sup>th</sup> century that diminish its

historical significance. In order to provide for the no build open garden area, the buildings on the site will be taken down.

The Rye Planning Board at their November 10<sup>th</sup> meeting voted unanimously 7 to 0 to approve the minor site plan development that allows for the .04 acre Parsonage property to be deeded, with the restrictions set forth in the amended contract to Mr. Philbrick in the exchange of 500 for 575 Washington Road.

Subsequent to the Planning Board approval of the minor subdivision application, David Choate, Tom King and the Library Trustees have filed a complaint in superior court seeking a temporary restraining order and injunctive relief. The injunction would temporarily prevent the demolition of the Parsonage building and may affect the ability of the Town to consummate the land exchange. A hearing on the merits of the case was held on November 23, 2020 and a court decision was not available at time of printing.

**Rye Town Hall named to National Register of Historic Places:** The New Hampshire Division of Historical Resources has announced that Rye Town Hall has been honored by the United States Secretary of the Interior with placement on the National Register of Historic Places for both its architecture and for its role as a center for politics and government.

The Rye Town Hall building was originally a 1½ story church built by the Methodist Society in 1839, it was elevated and turned into a 2½ story town hall by the Town of Rye, which purchased it in 1873. The renovation also lengthened the building by 10 feet and added a two-stage square tower with a belfry.

Although its interior was modified in the late 20th century to accommodate town offices, Rye Town Hall's interior retains many of its historic features. The first floor's original beadboard walls and six-panel solid wood doors are

connected to the second floor by a pair of wide elliptical stairways, added when the town purchased the building, that still have their original walnut handrails, round newel posts and turned balusters.

A large elevated stage, framed by decorative panels and with a bowed front, was added to the second floor circa 1875. Settees purchased for that space are currently in use on the first floor.

Payment records for bedding and heavy padlocks indicate that there may have been jail cells in the basement, as was often the case with local town halls.

As Rye's first building purchased for and dedicated solely to the consolidation of town government functions, Rye Town Hall was the center of community life from late 19th through the first half of the 20th century. Dances, concerts, whist parties, singing schools, oyster parties and immunization clinics are some of the wide variety of events that took place there. Community groups, including the local grange, Odd Fellows, Rye Dramatic Club, the Jenness Beach Society and several youth groups made use of the space.

The Rye Select Board is working to again open the second floor of the Town Hall for both meeting rooms and social activities by moving some of the Town offices to TD Bank building when the Parsonage/TD Bank exchange is completed.

**2020 Tax Rate Setting:** At their meeting to set the tax rate on November 13, 2020, the Select Board voted unanimously to use \$963,424 in fund balance to offset the tax rate thereby keeping the overall Town wide rate the same as 2019. The Select Board remains mindful of the effect the ongoing pandemic could have on residents' ability to make timely tax payments and felt strongly that there should be no increases in the tax rate. Below is a breakdown of the individual rates and the rates for the precincts:

The Town portion	\$ 3.10
The Local School portion	\$ 3.88
The State School portion	\$ 2.27
The Rockingham County portion	\$ .97
	\$10.22

# Selectmen's Message (continued from page 1)

In addition, the Precinct rates were set as follows: Rye Water District \$ .54; Jenness Beach \$ .16; Rye Beach \$ .34.

Rye residents should add the Town wide tax rate to their respective precinct rate to obtain the total tax rate for their property.

**Port Way Cell Tower:** The Town of Rye has been in negotiations with Verizon on a new cell tower since December 2017. This application was submitted because of Verizon identifying a "gap" in their coverage that extended from the northerly area of Rye and extending into New Castle. The original site of 120 Brackett Road was challenged by the planning board as it was on a busy street and in a single residential district and not in our cell tower overlay district. After a thorough investigation of alternate locations, preferably on town owned land, the new location was identified. 68 Port Way was chosen as an alternate to the Brackett Road because it has the same gap attributes without most of the negative characteristics associated with the Brackett Road location. Thus far all the necessary documentation has been acquired and a certificate of certification has been submitted to the state. Presently we are awaiting its return. We anticipate construction to begin in the spring. Traditionally, cell coverage in Rye has been spotty at best. The addition of this tower will greatly improve coverage and will enhance safety in this part of town. Concurrent with is process, the Select Board along with an ad hoc committee of citizens are actively engaged with identifying other similar locations on which to locate additional towers. In this time of pandemic, we are obligated to provide the most robust communication system as possible. Additionally, we owe a deep appreciation to the abutters of Port Way for their cooperation in this process.



**Rye Harbor Dredging Update:** Prock Marine of Rockland Maine began the dredging of Rye Harbor on Sunday, November 15 and will work 24/7 through March 15, 2021 to complete the removal of between 75,000 and 80,000 cubic yards of dredge material. The Material will be loaded on barges and deposited in the Corps of Engineer's approved dredge site north of the Isles of Shoals. Deep water mooring balls were removed from the water and stored in the Harbor parking lot in advance of the dredge. Residents of properties adjacent to the Harbor will be subject to noise and lights 24/7 throughout the dredge process.

**Lang Road/US 1 intersection construction:** The much-awaited reconfiguration of the Lang Road/US 1 intersection is planned for construction in the spring of 2021. This work will result in Lang road traffic planning to take a left on US 1 having to travel behind the Service Credit Union and connect to Longmeadow Road. They then will be taking a protected left onto US 1 south via the current traffic light at the intersection of US1 and Longmeadow and Atlantic Road. Traffic planning to take a right onto US1 will follow Lang Road to the current intersection at US1. The Tighe & Bond survey map shows the reconfiguration in bold on the map below.

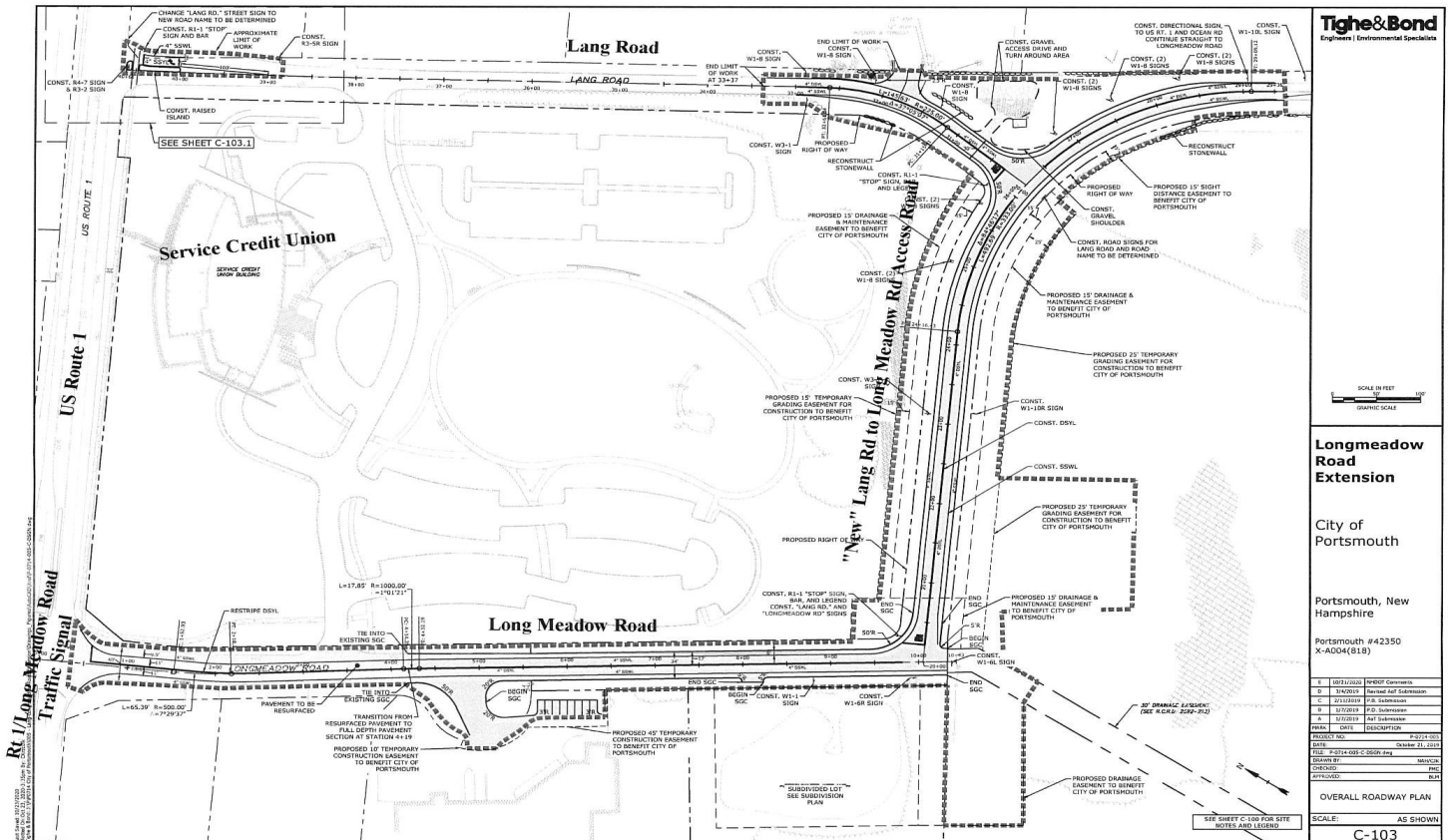

**Tighe & Bond**  
Engineers | Environmental Scientists

**Longmeadow Road Extension**

City of Portsmouth

Portsmouth, New Hampshire

Portsmouth #42350  
X-ADD4(818)

1	10/17/2020	PROJ. CHANGES
2	10/20/2020	REVISION OF SUBMISSION
3	01/13/2021	P.E. SUBMISSION
4	01/20/21	PER SUBMISSION
5	01/20/21	PER SUBMISSION
6	01/20/21	PER SUBMISSION

DATE: 01/20/21  
DRAWN BY: M. BROWN  
CHECKED BY: J. BROWN  
APPROVED BY: J. BROWN

OVERALL ROADWAY PLAN  
SCALE: AS SHOWN  
C-103

# Selectmen's Message

(continued from page 2)

**Route One Sewer:** 2020 has been a challenge for everyone and some priorities have changed or been set aside until life has returned to normal. Unfortunately, some important issues simply do not go away because we are distracted by other significant events. As noted in previous newsletters, is our ongoing attempt to get a sewer line established from the North Hampton line to Portsmouth. The first attempt failed for a variety of reasons not the least of which was the arrival of Covid-19. It put extreme pressure on the fund-raising attempts we were pursuing to pay for the project privately. In the last newsletter, we describe a process by which we could begin anew to establish the desired goal without the financial burden being borne by the taxpayers of Rye. The approach was by way of a T.I.F (Tax Incremental Financing district). Not only would this be an environmental safeguard against further threats from a variety of pollutants but a way of better utilizing what up till now has been difficult land to develop. The importance of the project cannot be overstated. The development and potential development along this corridor have become a significant target for developers. From the North Hampton line to Portsmouth there is a potential for 200 new residential units in addition to the 60 already approved and pending construction. All of these will be on septic. When layered over the Coakley land fill issue, this is not sustainable and is a potential hazard to our drinking water and over all regional environment. It is our desire to plan with all affected parties to produce an attractive, well thought out gateway to the town we all love. We will have listening sessions in the near future to explain and plan our next steps in the process.

**Trolley Barn:** The Town owned Old Trolley Barn, located diagonally across from the Town Hall, has been approved for sale by the Town with a portion of the proceeds to be used to renovate the TD Bank building for offices to be used by up to seven current Town Hall staff. This in turn will allow the second floor of the Town Hall to be used for meeting room space and for civic functions. (The TD Bank building with it 3.71 acres of land will

be transferred to the ownership of the Town when the Parsonage/TD Bank building exchange is completed). An appraisal of the Trolley Barn is underway (should be completed at the time this Newsletter is published). Once the TD Bank building ownership is transferred to the Town, the Trolley Barn will be placed on the market for sale to the highest bidder.

Rye Select Board,  
Phil Winslow  
Bill Epperson  
Mae Bradshaw

## Town Clerk/Tax Collector Update

With 2020 coming to an end and the Primary and General Elections behind us, it is time to go forward. A special thank you to our Moderator Robert Eaton, Deputy Town Clerk Amy Thibodeau, Supervisors of the Checklist, Dennis McCarthy and his workers, Rye Police and Fire Department, and all our election officials and staff that have worked together to make this election go smoothly during the pandemic. A special Thank You to all the Town Hall staff that has dealt and supported our office during this election time. It has been a challenge for both the Town Clerk's office and the residents on the changes we had to make to keep everyone safe.

The Town Clerk/Tax Collector's window hours to the public are Monday—Friday, 8:00 a.m. – 2:00 p.m. until further notice. Appointments will be required for new car registrations, marriage licenses and all vital record requests. These will be scheduled between 2:00 – 4:30 p.m. and can be made by calling 964-8562. These hours are subject to change due to the fact we will be short-staffed one person. Amy and myself are doing the very best to accommodate any business you may have in the Town Clerk/Tax Collector's Office. Below are some bullet points for the Town Clerk/Tax Collector's office.

- Second half Tax Bills have been

mailed out and the due date is December 17, 2020. We encourage residents to use the online payment method or to mail in your payment.

- A Drop Box will be placed in the lobby of the Town Hall for Tax Bill Payments Only. If you would like a receipt, please place a self-addressed stamped envelope with your payment. We are trying to eliminate contact and traffic in the Town Hall. Sorry for the inconvenience this may cause but we are doing our best for everyone to stay safe and healthy.
- 2021 Renewal for Boat Registrations may be registered at any time. All NEW Boat Registrations must wait until after January 1, 2021.
- Starting December 1, 2020 – All new car registrations will be processed by Appointment only.
- Starting December 1, 2020 – All Marriage License, Vital Records (certified copies of Marriage License, Birth and Death Certificates) will be by appointment only.
- 2021 Beach Parking Permits will be on sale after January 1, 2021 at the cost of \$25.00 per vehicle. A copy of a valid vehicle registration (property owner or full-time rental resident with Lease Agreement) is required.
- 2021 Dog License will be on sale beginning January 1, 2021. All Dogs must be licensed by April 30<sup>th</sup>. A current rabies certificate will be needed.
- Transfer Station Permits are available in our office. A registration must be presented for each vehicle you would like a permit for.
- We accept checks, cash or credit cards. Please be aware there is approximately a 3% surcharge for the use of a credit card that goes to the credit card company.
- Please take time to visit the town website ([www.town.rye.nh.us](http://www.town.rye.nh.us)). There are Icons that will take you to the right place to register your vehicles, pay taxes and sewer bills, license your dog and apply for copies of vital records.

Be sure to visit the Town Website for any changes that may take

# Town Clerk Update

(continued from page 3)

place during these unusual times. Our main focus is for everyone to stay safe and healthy but get the job done.

Absentee Ballot applications for the Town Election in March will be available on the Town Website beginning December 1, 2020.

Stay Safe and Healthy! Enjoy your loved ones and Happy Holidays from all of us in the Town Clerk/Tax Collector's Office.

Donna DeCotis  
Town Clerk/Tax Collector

## Tips from the Police Chief

**Winter Parking:** Winter is here and soon the snow will arrive. Residents and visitors are asked to park in their driveways during the night and during snow removal to assist Rye Highway Department with snow removal. The parking ban is in place from November 1st to April 15th.

**Snow Plowing:** If your driveway is plowed by a private contractor, please remind the contractor not to push snow across the road from your driveway.

**Holidays:** As we move forward towards holidays with Covid-19, below are some suggestions to consider when planning family gatherings for the holidays. <https://www.cdc.gov/coronavirus/2019-ncov/daily-life-coping/holidays.html>

Below are some general considerations for hosting a gathering that includes individuals from different households. Guests should be aware of these considerations and ask their host what mitigation measures will be in place during the gathering. Hosts should consider the following:

- Check the COVID-19 infection rates in areas where attendees live on [state](#), [local](#), [territorial](#), or [tribal](#) health department websites. Based on the status of the

pandemic, consider if it is healthy to hold or attend the gathering on the proposed date.

- Limit the number of attendees as much as possible to allow people from different households to remain at least [6 feet](#) apart at all times. Guests should avoid direct contact, including handshakes and hugs, with others not from their household.
- Host outdoor rather than indoor gatherings as much as possible. Even outdoors, require guests to wear masks when not eating or drinking.
- Avoid holding gatherings in crowded, poorly ventilated spaces with persons who are not in your household.
- Increase ventilation by opening windows and doors to the extent that is safe and feasible based on the weather, or by placing central air and heating on continuous circulation.
  - ◊ For additional information on increasing ventilation, visit CDC's information on [Cleaning and Disinfecting Your Home](#).
  - ◊ Winter weather can be cold, wet, and unpredictable. Inclement weather makes it difficult to increase ventilation by opening windows or to hold an event outdoors.
- If setting up outdoor seating under a pop-up open air tent, ensure guests are still seated with physical distancing in mind. Enclosed 4-wall tents will have less air circulation than open air tents. If outdoor temperature or weather forces you to put up the tent sidewalls, consider leaving one or more sides open or rolling up the bottom 12" of each sidewall to enhance ventilation while still providing a wind break.
- Require guests to wear masks. At gatherings that include persons of different households, everyone should always wear a [mask](#) that covers both the mouth and nose, except when eating or drinking. It is also important to stay at least [6 feet away](#) from people who are not in your household at all times.
- Encourage guests to avoid singing

or shouting, especially indoors. Keep music levels down so people do not have to shout or speak loudly to be heard.

- Encourage attendees to [wash](#) their hands often with soap and water for at least 20 seconds. If soap and water are not readily available, use [hand sanitizer](#) that contains at least 60% alcohol.
- Provide guests with information about any COVID-19 safety guidelines and steps that will be in place at the gathering to prevent the spread of the virus.
- Provide and/or encourage attendees to bring supplies to help everyone to stay healthy. These include extra [masks](#) (do not share or swap with others), [hand sanitizer](#) that contains at least 60% alcohol, and tissues. Stock bathrooms with enough hand soap and single use towels.
- Limit contact with commonly touched surfaces or shared items such as serving utensils.
- [Clean and disinfect](#) commonly touched surfaces and any shared items between use when feasible. Use [EPA-approved disinfectants](#) [external icon](#).
- Use touchless garbage cans if available. Use gloves when removing garbage bags or handling and disposing of trash. Wash hands after removing gloves.
- Plan and ask guests to avoid contact with people outside of their households for 14 days before the gathering.
- Treat [pets](#) as you would other human family members – do not let pets interact with people outside the household.

**\* The more of these prevention measures that you put in place, the healthier your gathering will be. No one measure is enough to prevent the spread of COVID-19. \***

**Vacation:** If you are planning to go away, even for just a few days, please make sure your home is locked. If you have a security system, use it; let your neighbors know you are going to be away. Always make sure the driveway and walkways are maintained. Whenever possible, ask someone to check the house and please let the Rye Police know you are away.

# Police Chief's Tips

(continued from page 4)



**Deer Crossing:** During this time of year, deer are on the move. We have several herds in town and they cross the roads frequently.

Please use caution when traveling around town.

**Invisible Fence:** We are receiving a lot of calls for loose dogs. Please make sure your dog always has his/her collar and tags on. If you have an electric fence, the battery in the collar needs to be replaced regularly. If the dog is wearing the collar and the battery is not working, the fence is useless. If your dog has his/her tags on, the officer will be able to return your dog to you. Snow on the ground will prevent an electric fence from working. Please check the fenced in area to make sure snow piles are not preventing the fence from working.

**Scams:** In the age of technology, scams are quite prevalent now and scammers are always looking for new ways to get your money. With the holidays upon us, please double check any packages arriving at your residence and notify the Rye Police if you find packages arriving with your address on them that you did not order. Scammers are tracking packages that are purchased with stolen account information and are waiting for the packages to arrive so that they can retrieve the fraudulently obtained items before the homeowner retrieves the packages.

**Jessica Doucette:** I regretfully accepted the Police Department Administrative Assistant's resignation. She has decided to stay home with her children. The most important job in America is being a parent. Watching Jess with her two children and husband she is responsive, trustworthy, and is loving. If you see me walking around lost this is why. As a police leader there is always someone who is the person behind the scene directing all great things. All the officers wish her, Mike, and the 2 kids the best and hope she will visit often. Thank you Jess.

Have a healthy, safe, and happy holiday season.

Kevin Walsh  
Chief of Police

# Rye Fire & Rescue Update

**Coronavirus:** At this writing there is some hopeful news on the pandemic amid increasing concern of a substantial uptick in Covid-19 related illnesses. Over the last four weeks or so state hospitalization numbers have increased from 11 to over 70 statewide. The rate of infections is increasing at a rate that will almost surely far exceed our highest infection rate to date. A couple of reminders:

- Covid Fatigue (yes, this is a real term): We have been responding to the pandemic now for over nine months. That is a very long time to remain vigilant about masks, social distancing, hygiene and the like. We are all human and it is very human to become complacent after such a long time. We all need to be reminded that social distancing, masks, remaining in our family pods as much as possible are all critical to stemming community transmission and safeguarding both ourselves and our neighbors.
- During the upcoming holiday season it remains important to follow these proven mitigation procedures and minimize the size of our usual holiday gatherings. The pandemic, on top of the usual holiday blues many folks experience, will be a very trying time for many. Let's safely check on our neighbors as best we can, especially those living alone.
- Rye Fire Rescue, your doctor's office and the hospital are safe places to turn to when you have medical needs. Medical agencies throughout NH have in place stringent transmission preventative protocols. Please, if you are in need of medical assistance do not delay seeking help! When you or someone you know is experiencing a medical emergency dial 911 and help will be on the way. Here at Rye Fire Rescue we proudly work hard every day to ensure safe, quality care for our patients! That has not, and will not change.

The hopeful news we spoke of includes recent reports that several encouraging, effective vaccines that are on

the horizon. Together, by remembering our proven prevention measures, we can minimize the transmission of Covid-19 through what we hope may be the final months of the pandemic.

**New Pumper Ladder:** The new pumper ladder arrived in Rye on October 28 brightening up an otherwise rainy day! The manufacturing process for this truck took almost 17 months from order to delivery. The process was delayed a bit due to the pandemic. Now that the truck is here we have been busy readying it for duty. Perhaps surprising to many residents, this is an involved process which will take approx. 4-6 weeks to complete. So Far we have:

- Taken delivery of the truck.
- Performed an up-fit on the truck. This includes:
  - ◇ Placing equipment where it will be stored on the truck.
  - ◇ Mounting the mobile radio in the cab (done by our vendor)
  - ◇ Mounting portable radios and chargers in the cab (done by another vendor)
  - ◇ Completed 4 days (1 per shift) of mandatory manufacturer orientation training.
  - ◇ Completed manufacturer's practical training session on aerial and waterway operations.
  - ◇ Completed 2 days of practical fire pump operations by an outside vendor.



(See Rye Fire & Rescue, page 6)

# Rye Fire & Rescue

(continued from page 5)

- ◇ At this writing the truck is at our dealer in Brunswick Maine for its first punch list maintenance. Much like buying a new house, there are always items that need to be addressed after taking delivery of modern fire apparatus like the pumper-ladder. The truck will be there for up to 1 week.



(More training)



After the truck returns from the dealer we will:

- Complete a tactical course on ladder operations put on by the manufacturer.
- Have all members complete a DOT 'cone' driving course. This course will help the apparatus drivers become accustomed to the particulars of safely maneuvering the new pumper-ladder.
- Finally, each member will need to accumulate several hours of driving time under non-emergency conditions to get proficient in driving this particular vehicle.

The truck will then be placed in-service for the protection of Rye residents and guests traveling through our community!

Mark Cotreau  
Fire Chief

## Public Works Update

The recent early snowfall was a small sample of what is just around the corner for us all. The highway department is currently preparing the roads for the winter driving season.

This preparation consists of a number of tasks, such as the installation of grade stakes at select locations to delineate the edge of the road shoulders, removal of encumbrances in the road right of ways, patching pot holes in the pavement, removing low hanging branches, and adding gravel to low road shoulders, to name but a few. In order to assist the Highway Department, I offer a few reminders to the residents.

- All sports equipment such as basketball hoops, skateboard jumps, and goalie nets should be removed from the limits of the road right of way. The only structures which are allowed within the town right of ways, without prior approval, are mailboxes; all others require approval from the Town. Please ensure any unpermitted structures are removed from the right of way. Keep in mind that the road right of way is not just the paved portion of the road, but in many instances extends as much as 15 feet beyond the edge of pavement.
- Residents who desire marking the edge of their lawns, to minimize plow damage, may install thin plastic road delineators, which can be purchased at any locale hardware store or building supply. These delineators may be installed along your road frontage but must be at least three feet back from the edge of the road pavement, towards your property.
- The use of items not intended for plowing delineation, such as metal rods, stones, and granite posts, should not be employed for road delineation. Delineators not properly located, or constructed of unacceptable material, will be removed by the public works staff.
- Mailboxes should be inspected to ensure the support structures can resist the forces of Mother Nature. Only mailboxes properly installed and actually struck by road maintenance equipment will be eligible for replacement by the Public Works Department.

- Alternate locations for vehicles currently parked within the road right of way should be secured. The Police Department will be ticketing vehicles parked within the right of way, and vehicles adjacent to the road during snowstorms may be towed, at the owner's expense.
- Sump pump discharges should not be directed into the roads, if so directed, it should be relocated to a location where freezing on the pavement will not be a problem.
- Maintain the area around and over area drains clear of leaves and debris or notify the departments of potential blockages.
- Residents should not plow, throw, or push snow into the road. There is an ordinance against this practice and a fine associated with it.
- Everyone is encouraged to watch for snowplows and give way to them when passing, in either direction. With a plow and wing the trucks cover a large portion of the road lane.

Everyone's cooperation is greatly appreciated by the Public Works Department.

Given the recent discussion about what is and is not allowed within the road right of way, now might be a good time to reiterate the permits necessary to work on or adjacent to the right of way.

- Relocating or installing a new driveway requires a \$75 "Driveway Permit".
- Excavating for installation of any utilities requires a \$100 "Trench Permit".
- Re-paving a driveway or installing road pavers requires a \$50 "Paving Permit".

Each permit can be obtained from the Public Works Department located at the rear of the Transfer Station.

Installation of a wall or fence requires the issuance of a permit from the Code Enforcement/Building Inspector. Should the fence or wall be proposed for installation adjacent to the right of way residents are required to consult with the Public Works Director for determination of the right of way limits, if possible.

Residents who live at the corner of roads should be aware that the Town's Zoning Ordinance requires homeowners to maintain adequate site

## Public Works Update

(continued from page 6)

distance from the corner. This ordinance states that landscaping and fencing be maintained a maximum height of no more than two- and one-half feet, for a distance of 50 feet in either direction from the road intersection.

Dennis McCarthy  
Public Works Director



We would like to take this opportunity to thank everyone that participated in Rye Recreation Fall Soccer for a great season and recognize our team sponsors BC Underwood LLC, Star Island Builders and Partners Bank who also provided a certificate for a build-animal kit to all participants.



Karen Gogola-Andronaco,  
V.P. Market Manager

With no facility access at this time we are working on alternative programming. For up to date program information please contact 964-6281 or visit [www.town.rye.nh.us](http://www.town.rye.nh.us).

Lee Arthur  
Recreation Director

## Planning Board Update

The Planning Board (PB) is well into its final quarter of 2020, having continued to conduct regular and subcommittee meetings on Zoom since March. This format has been successful due to the support from Kim Reed, Planning and Zoning Administrator, as she has timely provided voluminous packages, and seamlessly coordinated the Applicants, their teams, and Town experts to facilitate the PB's decisions. Thank you, Kim!

The Rules and Regs Committee, including Nicole Paul, Jeff Quinn, Kim, and Pat, has been active since late July. All proposed changes to the ordinances and land development regulations may be found on the Town of Rye website: <https://www.town.rye.nh.us/planning-board/pages/proposed-zoning-amendments-2021>. Guidance from Town Counsel Michael Donovan, and Town expert: Mike Cuomo, Septic Evaluator & Natural Resource Scientist, Rockingham County Conservation District, has strengthened the Committee's efforts throughout this season. Mr. Cuomo recently noted: "Rye wetland buffer provisions (190-3.1.H) are stronger than most towns and provide a measure of protection from near term sea level and water table rise."

The upcoming adoption of revised floodplain maps is an essential step forward to address the safety of Town residents and property (see: [https://www.town.rye.nh.us/sites/g/files/vyhlf3751/f/news/new\\_map\\_presentation\\_10-15-2020.pdf](https://www.town.rye.nh.us/sites/g/files/vyhlf3751/f/news/new_map_presentation_10-15-2020.pdf)) The Special Flood Hazard Areas (SFHA) will require additional measures in connection with Code Enforcement - Flood Plain Ordinance, and Planning Board - Land Development Regulations. The BOS, PB, Town Administrator Becky Bergeron, and Kim Reed have advanced the ordinance and procedural changes to meet the implementation date of January 29, 2021. The new maps will be incorporated into the Town's GIS system, available through the Town's website, as of their effective date. Currently, parcel level data may be reviewed at Parcel Change Viewer: <https://nhosi.maps.arcgis.com/home/webmap/viewer.html?webmap=29c460e03ced4a8e85f2cfed321117cb>. Workshops sponsored by NH Office of Strategic Initiatives and their planners: Jennifer Gilbert and Samara Ebinger, have provided significant guidance to assist the Town's efforts.

Meetings of the Technical Review Committee, chaired by J Lord, and supported by members: Jim Finn and Pat, have continued their review of various aspects of the Stoneleigh Subdivision on South Road. Expert advice by Steve Harding of Sebago Technics, Dennis McCarthy, DPW Director, and Danna Truslow of Truslow Resource Consulting, LLC have greatly assisted this process. The Developer and his team have responsively addressed the critical issues raised in the Spring. Recently, Ms. Truslow updated fertilizer guidance to address limiting factors in the Aquifer and Wellhead Protection District.

In closing, we wish to express our appreciation to Tim Durkin for his efforts on the PB, our gratitude to Nicole Paul for her commitment as a regular member through March 2021, and thankfulness to all PB members for their dedication.

Patricia Losik, Rye Planning Board Chair

## Rye Senior SERVE Update

Despite the many ongoing challenges the pandemic has created for our seniors and volunteer drivers, weekly grocery shopping and transportation to and from necessary medical appointments are still being provided.

While we have suspended use of the Rye Senior SERVE van for weekly shopping trips to comply with CDC recommendations, our dedicated volunteer drivers continue with their

efforts ensuring vital services are still being delivered. Our volunteers are the strength of Rye Senior SERVE programs and their sustained efforts are greatly appreciated.

Claudia Hackett does a remarkable job coordinating our drivers with Rye's seniors needing transportation for needed medical appointments and ensures both drivers and passengers observe recommended protocols.

Jim Delaney, Rye Senior SERVE  
(603) 436.6041



**Multipurpose Storage Facility  
Ribbon Cutting & Open House  
November 10, 2020**



**SHARING A COMMUNITIES ACCOMPLISHMENT**

The Town of Rye held a ribbon cutting and open house to celebrate the completion of the Rye Recreation Multipurpose Storage Facility located at 55 Recreation Road.

Residents, the Select Board, recreation commissioners, town staff, community leaders and the builder Jarrod Patten, JRK Builders NH LLC gathered to share in the community's accomplishment.

The ceremony included opening remarks from Gregg Mikolaities, Recreation Commission Chairman. He thanked those in attendance for their support, spoke about the project's history and brought attention to the building attributes and other improvements at the recreation area. The event was photographed by Frank Kennedy, Rye Resident.

**THE PROCESS**

**COLLABORATIVE EFFORT**

On March 13, 2018 Rye voters approved Warrant Article 13, to raise and appropriate the sum of one hundred fifty thousand dollars to construct the multipurpose recreation storage facility. The discussion on the need for proper program and storage space for Rye Recreation has been ongoing since 1999. Over the years the Recreation Commission has completed a Recreation Master Plan, conducted two town-wide recreation needs surveys, had an architect complete a facility and space needs assessment of Rye Recreation Facilities and the Select Board appointed members to a Rye Recreation Facilities Space Needs Assessment Committee.

At every turn the lack of appropriate, climate-controlled storage was identified as a critical shortcoming. Rye Recreation which provides a wide range of programs and services to residents, holds programs at more than 12 different sites, with supplies and equipment until now stored in 19 different locations.

Those present toured the Rye Recreation Multipurpose Storage Facility, which features 1,820 square feet of overall space at a cost of \$150,000/ \$82.42 a square foot. The concession area is 208 square feet, heated, overlooks the Ralph Morang Multipurpose Field, has a closet equipped to serve as a future restroom if decided and is where the timer for the exterior lights is located.

The heated storage area is 780 square feet, has double doors for easy entry, is furnished with shelving, has ample workspace and houses the irrigation controls. The unheated storage area is 728 square feet, has shelving and a garage door. Two community lockers each 52 square feet are accessible from the exterior of the building and are being used by Rye Little League and Rye Soccer Association. The electrical was brought underground to the building and the waterline was installed by the Rye Water District.



Left to Right: Stephen King, Gregg Mikolaities, Brett Mulvey, Cory Belden, Rye Recreation Commissioners and Lee Arthur, Recreation Director. Absent from photo Todd Cronin, Joseph Persechino and Georgina Saravia. Photo by Frank Kennedy



**RYE RECREATION**  
Building a strong community



## TIMELINE

### March 2018

- Warrant Article

### April 2018

- Rye Recreation Working Group Established

### August 2018

- Construction Layout Survey

### September 2018

- RFQ and Proposals Design/Build Advertised

### October 2018

- RFQ and Proposals Design/Build Site Walk
- RFQ Proposals Design/Build Deadline

### November 2018

- Rec. Commission Meeting, Builder Recommended
- Select Board's Meeting, Builder Selected
- Storage Container Leased
- Irrigation Disconnected

### December 2018

- Notice of Award Signed

### January 2019

- Demolition Permit Issued
- Demolition of Soccer Snack Shack and Utility Sheds

### February 2019

- Board of Adjustment Application Submitted
- Planning Board Meeting
- Conservation Commission Meeting, Overflow Parking Lot Entrance Relocation

### March 2019

- Design Build Contract Drafted
- Select Board's Meeting, Update Provided
- Select Board's Meeting, Builder Contract
- Building Permit Application

### May 2019

- Design Build Contract Signed
- Building Permits Issued
- Foundation Excavated and Poured
- Conservation Commission Site Walk, Overflow Parking Lot Entrance Relocation

### July 2019

- Underground Electrical and Waterline Installed
- Tree Removal
- Overflow Parking Lot Entrance Relocated

### August 2019

- Exterior Framed and Floor Poured

### September 2019

- Roof Installed

### October 2019

- Interior Framed and Electrical Installed

### November 2019

- Insulation Installed

### December 2019

- Drywall Completed

### January 2020

- Painting Completed

### February 2020

- Heating Unit Installed

### March 2020

- Certificate of Occupancy Issued

### April 2020

- Exterior Concrete Poured
- Disturbed Areas Loamed and Seeded

The former Soccer Snack Shack and adjacent utility sheds were demolished by the Public Works Department and the access to the overflow parking area was relocated in consultation with the Conservation Commission to the back of the building.

## SPECIAL THANK YOU

To the residents of Rye, Select Board, Budget Committee, Capital Improvements Program Committee, Conservation Commission, Demolition Review Committee, Planning Board, Zoning Board of Adjustment, Recreation Commission, Recreation Facilities Needs Assessment Committee, Rye Water District, Building Department, Finance Department, Fire Department, Planning Department, Police Department, Public Works Department, Selectmen's Office, Recreation Department, and Jarrod Patten, JRK Builders.



## Rye Public Library Events Winter 2020-2021

*In the depth of winter I finally learned that within me there  
lay an invincible summer.*

--Albert Camus (1913-1960)

Rye Public Library recently announced tripling our appointment schedule and introducing youth department browsing. See our website for details: [www.ryepubliclibrary.org](http://www.ryepubliclibrary.org). Despite the renewed viral wave anticipated for the season, we feel confident with this moderate increase of service as the Library building has had ultra-violet treatment equipment installed to treat airflow. With this enhancement, reduced staff and visitors on an appointment schedule can share space for limited time in as safe an environment as possible. Of course, our popular pick-up foyer service will continue: call for your request and we will let you know your pick-up number. We have served thousands of patrons via our evolving service methods. Many of you have continued to borrow electronically, foyer-pick up is tremendously successful and browsing appointments will continue unless regional conditions warrant a change.

### Ongoing Activities:

**Adult Book Discussion:** All are welcome to join these lively discussion groups via Zoom [or other platform as notified] Last Friday of each month at 1 pm!

12/18 *Why We Swim* by Bonnie Tsui [available on Hoopla]

1/29 *The Fixed Stars* by Molly Wizenberg [a Hoopla Book Club Spotlight]

2/26 *The Confessions of Frannie Langton* by Sara Collins [available on Hoopla]

**Remote Access Programming:** via Zoom [or other platform as notified] watch for reservation details in our bi-weekly newsletter or on the RPL Website. Wednesdays at 6:30PM

12/16 *Holiday Concert* with Dorothy Braker and Co.

1/20 *Granite State Gallery: NH Art Through the Years*

2/3 *Ultimate Presentation for Red Sox Nation!*

### FRIENDS OF THE RYE PUBLIC LIBRARY

New members welcome!

Zoom meetings resume in September. Second Tuesdays at 6:00PM[call RPL for details]

### **Museum memberships supported by *The Friends*:**

Children’s Museum of NH, Dover	Museum of Science, Boston, MA
Currier Museum of Art, Manchester	Strawbery Banke, Portsmouth
Historic New England	Ogunquit Museum of Art, ME
Isabella Stewart Gardner Museum, Boston, MA	Peabody Essex Museum, Salem, MA
Portland Museum of Art, Portland, ME	Seacoast Science Center, Rye
Museum of Fine Arts, Boston, MA	NH State Parks parking pass
	Woodman Museum, Dover

### *Museum Passes Donated by the Friends of the Rye Public Library*

Many of the Museums listed above offer virtual tours of their collections during the COVID 19 restriction. Just search for the museum by name in any search engine and click to find tour options.

**ASK A LIBRARIAN** – If you have questions about technology or how-to on your device [computer, phone, or tablet] call RPL at 603-964-8401 or email Lisa Breton [tech@ryepubliclibrary.org](mailto:tech@ryepubliclibrary.org). to set up a Chat or Zoom session for a Thursday afternoon slot. These sessions are process oriented rather than to troubleshoot device functionality. If you wonder how to download books and other materials to your device, create an e-mail account or manage storage, etc. this session is for you. If your device just crashed or won’t boot up, that’s beyond the scope here.

## **Rye Public Library Youth Department**

**Programming December 2020 – February 2021**

*more details at [ryepubliclibrary.org](http://ryepubliclibrary.org) (603) 964 – 8401*

All of the following events will be held remotely. For access links and information please contact us by email [contact@ryepubliclibrary.org](mailto:contact@ryepubliclibrary.org), visit [ryepubliclibrary.org](http://ryepubliclibrary.org), or call (603) 964-8401

### **Youth Programs**

**Story Time for Toddlers & Preschoolers**  
Thursdays & Fridays 10:30am

**RPL Teen and Adult Writers’ Group,**  
1st & 3rd Tuesdays of the Month  
6:00-8:00pm

**Book Bundles: request and pick-up**  
**Call to request a curated collection on a favorite topic or by a favorite writer**

**YAttitudes Book Club**  
*Check website for book titles*  
Second Tuesday of the month 6:00-7:00pm  
Grades 6+

## Conservation Commission Update



Rye Conservation Commission (RCC) is pleased to report that Jim Raynes, who served for over a quarter of a century

on the Rye Conservation Commission, was honored this fall with the prestigious James Hayden Award. The award recognizes those that have made significant contributions in their communities or the greater region in natural resource conservation and planning. Jim's involvement and achievements that illustrate his lifelong commitment and work for conservation in greater New Hampshire include: eight years on the New Hampshire Association of Conservation Districts, 15 years on the Rockingham County Conservation group and receiving the President's Award from the New Hampshire Association of Conservation Districts.

Many protected lands and scenic vistas in Rye can be credited to Jim's tireless work to conserve our town's natural resources. Jim has been at the front of successful efforts to preserve the rural character of Rye through acquisitions and wetland protection. His quiet appreciation for nature and way of working with Rye landowners has seen him cultivate strong relationships, sometimes spending years working with families and finding consensus in conserving important lands. Thanks to Jim, Rye stands out among seacoast towns for its preserved open spaces and natural resources. Conservation has always been a joy and a passion for Jim Raynes. His years of hard work and his commitment to protecting our small town's natural resources have had a large and lasting impact. Those who have worked alongside Jim on the RCC board are pleased to see him recognized for his heartfelt dedication to his life's cause. We know it is safe to say that for Jim his substantial contributions to land conservation are their own reward. RCC is poised to dedicate in Jim Raynes' name some 55 acres bordering the Signature Drive development on South Road. More information on the timing of this will be forthcoming.

In other news, at long last, RCC has acquired 78 acres at 81 West Road.

As is sometimes the case, RCC has worked on this acquisition for almost six years. This parcel adjoins Southeast Land Trust conserved property in North Hampton, making it possible to walk from West Road to South Road entirely on conserved property. Please thank Patricia Brown, with whom RCC has had the pleasure of working on this project.

In addition, RCC has advanced its mission through updating of our Forest Management Plan and by complying with an unfunded state mandate.

First, RCC commissioned an update of the Rye Town Forest Plan that was approved by the Commission in June, after extensive RCC review and public hearings. This 70-page document includes a detailed evaluation of current conditions in the Rye Forest and recommendations as to how the Town of Rye can continue to be a good steward of this precious resource.

Another initiative with important benefits is the Natural Resources Inventory (NRI). RCC issued a detailed Request for Proposals to obtain this for Rye earlier in the year. A subcommittee of the RCC met virtually several times just to get the details right. The NRI is required by RSA 36-A-2 and will allow RCC to apply for grant money that would not otherwise be available, among other benefits. An NRI compiles information on important, naturally occurring resources within a given locality (e.g., municipality, watershed, or region), such as forests, farmlands, streams, lakes, wetlands, and rocky ridges. Cultural resources, such as historic, scenic, and recreational assets are often included in an inventory. NRIs are comprised of maps, data, and a report that describes the resources, project goals and recommendations for next steps. As well as being a stand-alone product, the NRI can also be integrated into a master plan, conservation plan or watershed plan. By visualizing an area's resources—where they occur and how they relate to each other, their surroundings, and existing development—an NRI provides a strong foundation for informed land-use planning and decision-making. NRIs also serve as the basis for identifying conservation priorities and other strategies, such as local regulations to protect natural resources, and identify the need for more detailed studies such as wildlife

habitat assessment or wetland evaluation.

Finally, Goss Barn got new hayloft windows and new barn sashes. Stewarding this important asset is critical to the future of what will only become more important in the years to come: opportunities for local, organic food production. The Goss Farm community gardens were expanded to create more garden plots and were sold out this year! Thank you to all of our volunteers who helped make this a successful year!

And of course, RCC continues to maintain and blaze existing trails, look for additional appropriate property to be conserved and actively seek out property owners to partner with who are interested in conserving their properties. Additionally, the RCC conducts public hearings each month to evaluate wetlands applications, which routinely call for site walks on another day.

Take a look at the RCC article from the last town newsletter – it describes some of the trails made possible and maintained by RCC! If you like to walk, bike, bird watch or just enjoy being outside, check out our RCC trails!

Stay safe and well.  
Rye Conservation Commission

## Budget Committee Update

The Budget Committee met on November 19th for the annual day long meeting with department heads. Increases for cost of living adjustments, health insurance and retirement plans will be included in next year's budget. We will look at these increases vis-a-vis other costs to maintain a sensible total budget for the residents of Rye. The Budget Committee's schedule is on the town website calendar and the public can join via phone or zoom. See the town website for accessibility.

For your convenience the meetings are listed here: Town budget, Warrant Articles and unfinished business, Thursday, December 10th at 6:30pm. Public hearing January 14th at 6:30pm. School budget Work session, warrant articles December 8th at 6:30pm. Public hearing January 13th at 6:30pm. Please join us; we would appreciate your input

Jaci Grote, Chair  
Budget Committee

## Historic District Commission Seeks Protection of Rye's Historic Buildings

The Rye Historic District is the earliest Historic District in the State of New Hampshire and probably the smallest. This 1960's experiment has been successful in providing harmony in the appearance of the Rye Town Center.

The Commission received a Certified Local Government grant this year to engage a preservation expert. The Commission has begun work with Dominique Hawkins to help the commission create Design Guidelines for the District which includes the Town Center, the New Hampshire Isles of Shoals

and the Cable House. In working with this consultant, the Commission is considering an overlay of the whole town which would identify all historic structures of varying significance, built from the late 1600's into the first half of the 20th century. Most buildings in Rye that are over seventy years old have some architectural significance.

The current historic district is very small and covers a very small percentage of the historic houses and other buildings in Rye. Such an Overlay District would recognize the value of all historic houses and also increase the value of the building, as being a recognized part of a very historic community.

The Commission will seek input from property owners for this project. There are approximately 350 houses and other buildings in Rye built before 1900

which could be identified as having historic significance. The Commission is trying to assess how many were built before 1900 and would appreciate hearing from anyone who owns a house in that time period.

Please contact Alex Herlihy, Historic District Commission, Rye Heritage Commission and Rye Historical Society at: [alexherlihy@comcast.net](mailto:alexherlihy@comcast.net) or call: 997 6742.

Alex Herlihy, Chair  
Rye Historic District Commission

## Rye Heritage Commission Update

The Commission continues to investigate the acquisition of Pulpit Rock Tower. We are working closely with the Friends of Pulpit Rock Tower, who currently own the historic property. The history of the tower in World War II is seen as an asset to the town and should be preserved for posterity. The Commission plans to serve as ambassadors for the tours in Spring 2021.

On the Town Hall Front, in 2021 the Commission looks to continue its preservation efforts of Town Hall, with installations of storm windows. The Commission will also begin fundraising effort to help with other needed repairs to the historic building.

One of the responsibilities of the Commission is the oversight of the town's sixty-plus graveyards. Currently, only a handful have been adopted and we would like your help in maintaining them. We need people to help take on the care of these graveyards. It is also a little-known fact that graveyards can be "adopted" by descendants or town residents.

The Rye Heritage Commission has digitized the basic information about each graveyard, and it can be seen on the town web site: <https://www.town.rye.nh.us/heritage-commission> Under the Graveyard Notes and Photo Tabs.

One graveyard that has been restored to its prior state is the Foss Family Graveyard, is located on Washington Road near Foss Beach.

## RYE HISTORIC DISTRICT MAP

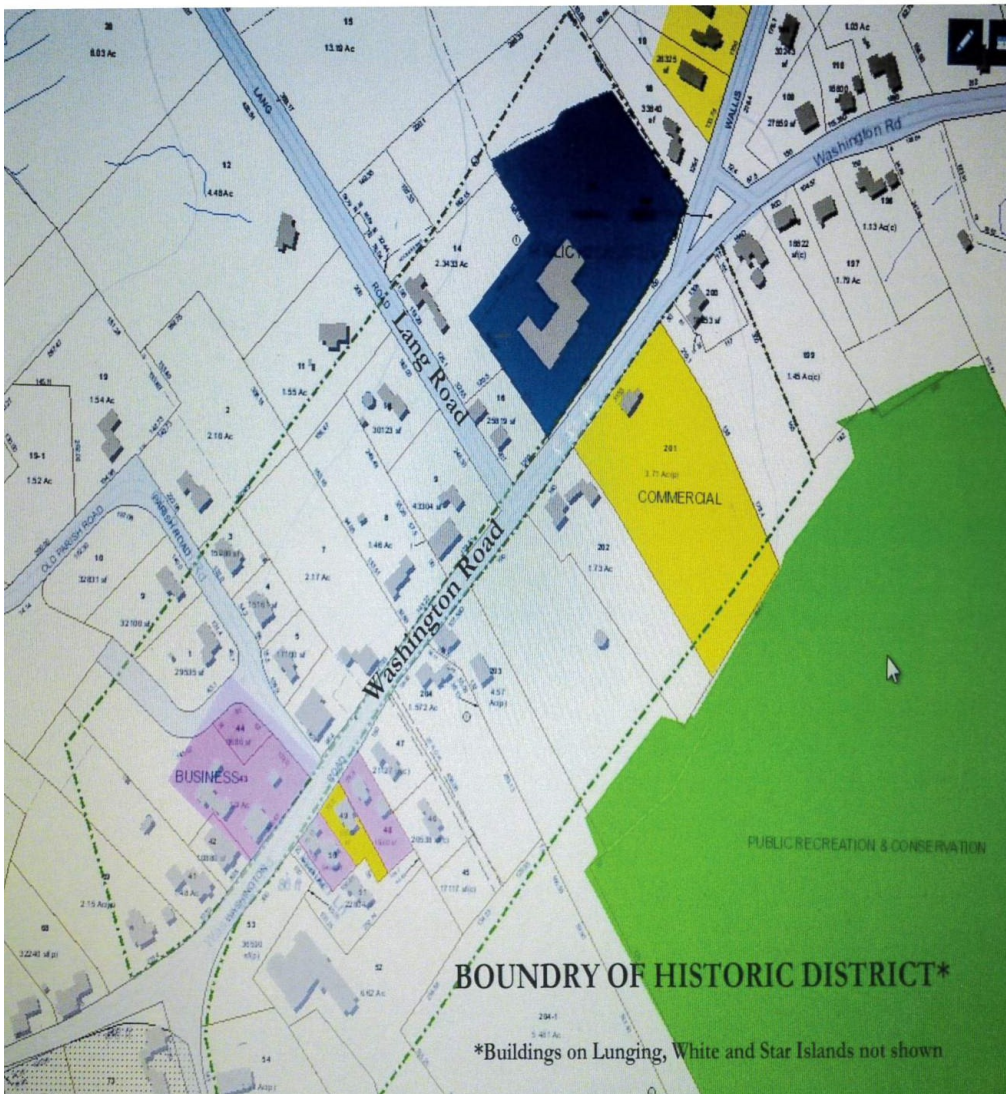

# Heritage Commission Update *(continued from page 13)*

Below I have included a summary of how “adopting” a graveyard works in the town of Rye.

## How Does “Adopting” a Graveyard Work?

A 2012 New Hampshire state law clarified the status of these graveyards (as opposed to large public cemeteries) which every town has.

The highlights of the law are:

1. The abutters do not own the graveyards and it is a felony to disturb it; so, they are, in a sense, sacred lands and entrusted to the care of the public.
2. Any descendant of people buried in the graveyard has right of first refusal to be the designated caretaker (adopt the graveyard) RHC advertised through a legal notice for descendants to come forward and become the caretaker.
3. If no descendant comes forward, RHC publicizes the need for abutters or anyone else in town to adopt the graveyard.
4. Abutters need to be informed by RHC when there is an official adopter.
5. If there are any graveyards not on a roadside location, caregivers or visitors must seek permission of the landowner to cross their property to reach the graveyard.

The need to preserve this aspect of town history is great, as headstones can be damaged by encroaching vegetation and the elements.

For a copy of the list of roadside graveyards you may write to [info@ryenhistoricalssociety.org](mailto:info@ryenhistoricalssociety.org), and again I encourage if you are interested to check out the town website for digital records on graveyards throughout the town.

If you would like more information on caring for graveyards and how you can preserve Rye history, or if you are now caring for a graveyard informally, contact Alex Herlihy at [alexherlihy@comcast.net](mailto:alexherlihy@comcast.net) or (603) 997-6742.

We take great pride in our role as steward for the rich culture of the town that we are all blessed to call home.

Currently, we meet on the second Thursday of the month at 3:30 PM via Zoom. We welcome you to join us. There is one vacancy for alternate positions. If you are interested, please contact myself [walshrye@gmail.com](mailto:walshrye@gmail.com) or Janice

Ireland [jireland2@town.rye.nh.us](mailto:jireland2@town.rye.nh.us).

The Commission joins me in wishing you all a wonderful holiday season. For 2021, let it be bright, prosperous, and healthy new year!

Phil Walsh, Chair  
Rye Heritage Commission

## Rye Historical Society News

Through special exhibits and regular programs and museum hours, the society aims to engage people in the vital aspects of Rye's history so that current issues may be better understood, and future plans respect the natural and human history of the town.

**Museum Report:** The Town Museum is being lovingly maintained even as it awaits new visitors and new exhibitions. The Board is ensuring that our lighting and climate environment is conducive to the preservation of our collection. This will involve investments in new shades, aspects of our lighting system, and strategic management of the HVAC system.

The 2020 expense budget was dramatically reduced due to changes brought on by COVID-19. Fortunately, we anticipate only a very small operating loss (if any), due primarily to a significant maintenance item that was budgeted and implemented in early 2020. All other major expenses were delayed for 2021 fiscal year or beyond. Membership income was up, even while grants were down.

We have had a regular stream of requests for one-on-one visits to the museum to conduct research or view specific objects. Remember that you can call the number on our website if you would like to request such a visit. Masks are required.

**Collection News:** Brand-new Board member Lewis Karabatsos is leading a comprehensive project to professionally catalogue the RHS collection of objects, documents, and photographs. Once complete, the entire collection will be searchable online and will be more manageable for Society leaders and volunteers. This is a multi-year project on which we will

report regularly.

**Programs Update:** Like the majority of our sister organizations we were not able to present programs in person this year, but we are now experts on Zooming and virtual presentations! Keep an eye out for virtual program dates and times for 2021. You will not want to miss the program presenters that Becky Marden and Alex Herlihy have recruited – the topics will inspire even the most screen-weary audience!

**Governance:** Kelly Lewis is taking the reins on identifying, recruiting, and training new Board members as well as ensuring that our governing documents are up to date and thoroughly maintained. We are looking for 2-3 new Board members this year who have specific skill sets. Send an email to our general email address on the website if you are interested.

**Enjoy our town with the RHS Walking Tour:** We're all out walking more! Why not take a new route and learn about some historic homes and locations in our town? We have a walking tour on the **Izi Travel** app (available at the App Store.) Download the app and you can search for Rye Beach Block. Follow the instructions for a fantastic guided walking (not driving!) tour of the Rye Beach Precinct.

**FACEBOOK LIVE – Reading from *Just Rye Harbor*: Every Sunday Evening at 5:00 p.m.!**

**Interested in History? Join us as a program volunteer.** We are working on an Old House Documentation Project and would love to have your assistance. Here are the tasks we need help with:

- 1) Finding the numbered road addresses for many of the houses for which we have old photos
- 2) Organizing and filing the photos and information on houses in the collection
- 3) Crafting and distributing a letter to all old homeowners to seek info on their house

If you are interested in volunteering, please send an email to [info@ryenhistoricalssociety.org](mailto:info@ryenhistoricalssociety.org).

**Thank you to our Members!** A heartfelt thanks to our members, whose generosity has provide more than \$5,600 so far in this year's membership drive. We're so grateful for your support and look forward to seeing you soon.

# Historical Society News

(continued from page 14)

**Check out our new website and follow us on social media.** We have updated our website so that you can find out about programs and events more easily. [www.ryenhistoricalociety.org](http://www.ryenhistoricalociety.org). Click on our YouTube channel to view virtual tours, readings, insights, and more: <https://www.youtube.com/channel/UCQ3Z4oZ6BYI9dXCTGblMjow>. Follow us on Facebook (Rye Historical Society – NH) and Instagram (@ryenhistoricalociety).

The Rye Town Museum houses a vast collection of regional and cultural information and items and features curated seasonal exhibits. Open by appointment. For an appointment write to [info@ryenhistoricalociety.org](mailto:info@ryenhistoricalociety.org) or call (603) 997-6742 .

Janet Clarkson Davis, President  
Rye Historical Society

## Rye Mosquito Control Update

The mosquito season is over and the end of 2020 is in sight. Very few people will be sad to see this unusual year end. The National Oceanic and Atmospheric Administration (NOAA) reports the summer of 2020 was the driest on record in New Hampshire. The drought was already affecting the number of mosquitoes in our traps by August. Only two batches of mosquitoes tested positive for West Nile Virus (WNV) in New Hampshire. One batch was from Manchester and one from Nashua. None of the mosquitoes trapped in NH tested positive for Eastern Equine Encephalitis (EEE). NH Department of Health and Human Services confirmed four human cases of Jamestown Canyon Virus (JCV) in 2020. One adult tested positive from each of the following towns: Bow, Dunbarton, Epsom and Loudon.

Mosquito batches sent to the State for testing were near all-time low levels. The mosquitoes that thrive during a drought are container mosquitoes and

salt marsh mosquitoes. New moon or full moon tides flood salt marshes at least once a month so drought conditions have little impact on those species. The small amount of rain we received this summer provided enough water to renew mosquito activity in tires, birdbaths, boats, buckets, wheelbarrows, tarps and catch basins. Species of mosquitoes that utilize container habitats are capable of transmitting diseases including WNV, EEE and the ZIKA virus. ZIKA mosquitoes haven't yet been found in New Hampshire.

Dragon Mosquito was hired for the 2020 season and began larviciding for the Town of Rye in mid-April and continued into October. Dragon uses *Bacillus thuringiensis israelensis* (Bti) to kill mosquito larvae in the water. Bti is a naturally occurring bacterium found in soil. Bti will not harm people, pets and other animals, aquatic life, or other insects, including honeybees. Catch basins were sampled and treated to combat disease carrying mosquitoes using another product derived from a naturally occurring soil bacterium, spinosad. School grounds, town trails and recreation areas were treated as requested to combat adult mosquitoes and ticks. Mosquitoes were trapped at five locations throughout town. None of the mosquitoes trapped in Rye tested positive. Sixteen new greenhead fly traps were constructed and existing traps were repaired. All the traps were set out on the salt marshes prior to the greenhead flies hatching in July. Rye's greenhead traps even showed up on an episode of the current season of North Woods. Look for the episode with the gray seal at Parsons Creek.

Tick populations suffer temporarily during a drought. Fewer ticks means less Lyme disease, as well as less Anaplasmosis, Babesiosis, Ehrlichiosis and Powassan Virus. Unfortunately, the list of tick diseases is growing as more types of ticks are found in our region bringing more types of diseases with them. Ticks remain active throughout the winter when temperatures are above freezing, and the ground is not covered by snow. After spending time in an area likely to have ticks, check yourself, your children and pets for ticks. Young ticks, called nymphs, are the size of a poppy seed. Adult black-legged ticks are the size of a sesame seed. Both nymph and adult ticks can spread diseases.

Arboviral disease is intermittent and cyclical in nature. NH has not seen significant WNV or EEE this season. However, arboviral diseases are a continuing source of severe illness in the United States each year. Mosquito populations drop in drought years but when the water table returns to normal, mosquitoes rebound and disease returns. The increase of mosquito-borne diseases will continue as warmer temperatures expand the range of mosquito species and lengthen the mosquito season.

Public health stories have become part of everyday news cycle. Until there's a wide spread vaccine, the pandemic will continue to affect our lives. Let's hope next year can be more "ordinary".

Tim Sanborn, Chair  
Rye Mosquito Control Commission

## Rye Energy Committee Update

The town continues to make progress reducing electricity costs and carbon emissions. The upgrade of the Schools to LED lighting was completed last December and the lighting upgrade for the Library, Public Safety Building and Transfer Station should begin soon. These upgrades will contribute significantly to electricity and emission savings.

In July Eversource reduced its electric supply rate by 15% from 8.036 to 7.068 cents per kWh. This is their lowest rate in recent history and holds until January when it may change again. Some town facilities switched to competitive suppliers when their prices were less than Eversource. However, with this rate decrease we have recommended that all town facilities using competitive suppliers switch back to Eversource.

You can compare electric rates from all competitive suppliers on this NH PUC webpage <https://tinyurl.com/y77ux45e>.

There has been some progress on the solar installation project. The School Board voted last December and again

# Energy Committee Update

(continued from page 15)

this October to proceed with the installation of solar panels on the elementary and junior high schools. These panels will not only save money and stabilize electricity costs, but they will significantly reduce town-wide carbon emissions.

As for the town and water district solar installations, after extended discussions with our solar vendor, the economics, due to size and reduced electric rates, do not support proceeding at this time. We are considering a small solar installation on the roof of the Transfer Station garage and will report back if conditions make the economics more favorable.

Committee members have participated in several conversations about the electric aggregation legislation SB 286, or Community Power, with nearby communities and the Clean Energy NH organization. By residents voting to adopt Community Power the town would be authorized to aggregate town-wide electric use to negotiate reduced electric supply rates. These rates, which may include a renewable energy option, would become the default electric service for all town residents and commercial customers. Residents would have the option to opt-out if they don't want to accept the negotiated rate. We will continue to closely monitor and report on Community Power activity.

We wish to welcome our newest committee member Nancy Siopes and to thank committee member Matt Marra as he transitions to new opportunities.

There is still another committee position open so if you're interested in joining please contact us from the Town website.



Rye Energy Committee  
Howard Kalet  
Tom Pfau  
Carl Nicolino  
Lisa Sweet  
Nancy Siopes

## Rye Water District News



### Drought Conditions Update:

Most of the state of NH has been in some type of drought condition since the latter part of this spring, including Rye. To compound the issue, the RWD has seen record water usage this past summer. On October 23<sup>rd</sup> the Select Board implemented a mandatory water restriction on irrigation activities which will expire on November 30<sup>th</sup>. The RWD Commissioners concurred with this action. With fall here and winter on the door step the water demand for irrigation has dropped off, but the drought has not dissipated. The Rye area remains in a moderate to severe drought category. The following is the November 5<sup>th</sup> weekly update issued by NHDES on the current drought status; "Outlooks for mid-November indicate precipitation received is likely to be normal to slightly above normal. Since last week, the U.S. Monthly Drought Outlook has been released and indicates it is unlikely there will be more drought improvement by the end of the month." The amount of precipitation that is received over this fall and winter will have an effect on drought conditions as we move into next spring and summer. The RWD will continue to monitor drought conditions as we move forward and make the necessary water usage adjustments as warranted.



### Fire Hydrants/Snow Removal:

Fire hydrants are now winterized and snow markers are being installed throughout the District. We ask for your help in clearing snow away from hydrants near your property. This will be invaluable in an emergency. Please remind your snow plow operator that clears your driveway, snow should never be pushed or piled up on or near fire hydrants. It's unlawful to do so per NH RSA 236:21.

### Upcoming Capital Improvement Project:

The RWD is moving forward with two system improvement projects, the Garland Road Pump House Refurbishment and Wallis Road Waterline Replacement. The Garland Road Pump House project consists of

providing for system improvements focusing on electrical modifications and updates, using energy efficient components, and safety improvements. Work on the Pump House project will be starting in the December/ January time frame. The Wallis Road Waterline Replacement project starts at the intersection of Ocean Boulevard running west up Wallis Road approximately 1000 feet to the vicinity of Park Ridge Road. This project will address several issue in this area: valves at the Wallis Rd/Ocean Blvd connection are in need of replacement, the waterline runs close to the Red Roof market building (with several feet of the foundation) and needs to be moved further away for safety reasons, iron waterline through the marsh needs to be replaced with HDPE material for better corrosion resistance, and the water line size needs to be increased from 8 inch dia. to 12 inch dia. to improve water flow in the area. Work for this project is anticipated to begin this spring or fall, working to avoid the summer traffic impacts.

### RWD Office Access:

Due to the continuing issues associated with Covid-19, the RWD Commissioners ask that patrons minimize accessing the RWD office located on Sagamore Road. If it is necessary to talk to District personal, we ask that you please call or e-mail first to try to address any questions or concerns. If it becomes necessary to visit the office, we ask that you please wear a mask.

### Rye Water District Website:

The Rye Water District's Website, [www.ryewaterdistrict.com](http://www.ryewaterdistrict.com), provides information about the RWD and various activities on going or planned. Additionally, the website provides information on: Customer Service, Forms & Reports, News and Notices and RWD contact information. It also provides for on-line account review and bill paying. The most recent report posting is the NHDES Tri-Annual Sanitary Survey Report, dated October 23, 2020

### Commissioner's email:

If you have any issues or concerns with the water system operations feel free to contact the commissioners via email at: [commissioners.ryewater@comcast.net](mailto:commissioners.ryewater@comcast.net)

Rye Water District Commissioners  
Tom Clifford  
Art Ditto  
Ralph Hickson

Visit the Town website  
<http://www.town.rye.nh.us>  
for news and up to date  
information about the Town, including  
meeting notices,  
agendas and minutes



## Rye ♻️ Recycling – Let’s Do It the Rye-ght Way!

This year has been like no other year in our lifetime. The pandemic has hit everyone hard. Recycling is no different. In March, when everything shut down, recycling basically stopped also. At the Transfer Station we couldn’t get rid of bulky, metal, or wood. We could only throw our household items away. And the Swap Shop closed.

Over the rest of the year, things we couldn’t recycle, at the beginning of the pandemic, have been coming back slowly, but it is coming back.

**You need to think before you throw it away!** To keep everyday items that are still in good condition such as furniture, clothing, house goods out of the landfills here are a few suggestions. You can donate those items to local community organizations such as the Salvation Army Store, Goodwill, Operation Blessing, Savers, The Restore, Journey Home to mention a few. For any of these places, please call first before going. Due to the pandemic, store hours may change and some of these places will not take some items. Not all the stores listed take furniture or others might only take clothes or house hold items. It only takes a few more minutes out of your busy day to bring your old unwanted items to any of the organizations listed above.

**We still need your help!** The Rye Recycling Education Committee still has openings for more members. Right now with the pandemic, we are not meeting in person, but when we can again, we meet at the Rye Public Library on the third Tuesday of the month at 6:30 PM. All interested residents are encouraged to attend.

The last point, be safe, wear a mask when out in the public, and please follow the CDC rules. If you do these few simple steps, we can all get through this.

Thank you,  
John Provencher, Chairman  
Rye Recycling Education Committee



## Rye PTA: Small Town Bright Lights Contest

The Rye PTA invites Rye town residents to spread the holiday cheer this holiday season for the 1st annual Small Town Bright Lights contest. Show neighbors and community members your most creative holiday display for a chance to win a cash prize. Bright and festive houses will be extra special this year as many traditional holiday activities may be cancelled due to Covid-19 restrictions. Let’s give community members an extra holiday season this year and something to ‘light’ us up!

The event runs from December 1- December 22. If you would like to participate, you must register by December 11th. Please fill in this FORM to enter.

**\*\*Please note:** your address will NOT be shared publicly when you enter. The address will only be seen by the judges and the organizers. You will pickup a small stake to put in your front yard to show you are participating.

Local Rye community members will be judging the displays from December 18-21 and the 1st, 2nd, and 3rd place winners will be announced on Tuesday, December 22.

### Contest Rules:

- The contest is free to enter
- The contest is for Rye residents only
- Only decorations visible from the roadway will be considered a part of the display
- Entrants must have display on for the duration of the judging period

By entering, you agree to have a small sign in your yard showing you are part of the contest. This will be provided by the Rye PTA. You will receive an email where to pick up your stake once you enter.

<https://www.facebook.com/events/1803227609830010/>

Email [ryesmalltownbrightlights@gmail.com](mailto:ryesmalltownbrightlights@gmail.com) with any questions.

### Mark Your Calendars Now

- ◇ Budget Committee Work Session School Proposed Budget Ending June 2022, Tuesday, December 8, 2020, 6:30 p.m. Via Zoom
- ◇ Budget Committee Work Session 2021 Town Budget Thursday, December 10, 2020, 6:30 p.m. Via Zoom
- ◇ Budget Committee Public Hearing School Budget Ending June 2022, Wednesday, January 13, 2021, 6:30 p.m. Via Zoom
- ◇ Budget Committee Public Hearing 2021 Town Budget, Thursday, January 14, 2021, 6:30 p.m. Via Zoom
- ◇ Deliberative Session (First Session of Town Meeting), Saturday, January 30, 2021, 9:00 a.m. Rye Junior High School
- ◇ Precincts Work Session & Public Hearing Tuesday, February 2, 2021, 4:00 p.m. Via Zoom
- ◇ Snow Date Deliberative Session Saturday, February 4, 2021, 9:00 a.m., Rye Junior High School
- ◇ Municipal Election (Second Session of Town Meeting), Tuesday, March 9, 2021, 8:00 a.m.– 7:00 p.m. Rye Elementary School

# Sewer Department Update

**Financially Speaking:** The Rye collection system was constructed in the early 1990's and consists of 6.9 miles of gravity sewer and 3.5 miles of force main. The Town of Rye wastewater collection system discharges to the Town of Hampton and is treated at Hampton's Wastewater Treatment Plant (WWTP). As part of the current Inter-municipal Agreement that is good until November 16, 2024, Rye is responsible for contributing to the Town of Hampton WWTP upgrades (Rye's share 4%). Significant upgrades are needed at their wastewater treatment plant and as a result the Town of Hampton will be acquiring a 20-year bond for \$11.78 M est. of which Rye's share is \$471,640 est. with \$33,435.40 est. payable in the first year (2023). Please see the table below indicating the current list of capital projects budgeted for in 2021.

Year	Total \$	Rye's Share	2021	Upgrade Description	Final Payment Year
2005	\$4.75 Million	\$190,000	\$10,901.44	Additional clarifier, dewatering equipment, sludge thickening facility	2024
2009	\$1.38 Million	\$55,200	\$3,500.76	Process/control building, replace generator, upgrade headwork's	2028
2011	\$1.265 Million	\$50,600	\$3,434.36	Sludge monitoring and handling, NPDES Engineering	2034

The proposed sewer budget for 2021 is \$341,210 which includes \$44,500 that is recovered by the owner of Adams Mobile Home Park. This is a \$18,501 increase over last year's budget and accounts for a \$47,776 decrease and \$66,277 increase. Most of the decrease and increase is attributed to the elimination of the part-time position and the implementation of a full-time position.

The current sewer rate is .075 cents per cubic feet of H2O consumption. It is projected that the rate will increase by .5 - 1 cent in 2021. It is important to note that Rye does not bear the full cost of a wastewater treatment facility as the flow is treated at Hampton's WWTP and that the current rate is amongst the lowest in the state.

Local Residential 2020 Sewer Rates (Lowest to highest)

#	Utility	0 cf	100 cf
1.	Rye	\$0.00	\$7.5
2.	Dover	\$0.00	\$9.05
3.	Newmarket	\$0.00	\$12.72
4.	Portsmouth	\$0.00	\$15.75
5.	New Castle	\$0.00	\$18.98

The original bond for Rye's sewer service in the amount of \$4.4 million that was shared (40%, Town of Rye general fund and 60%, users of the sewer services) was paid off at the end of 2012. It is important to note that 100% of the Sewer Department Budget is covered by fees to users.

The Sewer Budget operates out of fund 2. Revenues received from fees and charges are deposited into the fund and department costs are expended from the fund. The monies can accumulate from year to year and are not deemed part of the general fund; the fund must be self-supporting.

Lee Arthur,  
Sewer Administrator

**2021 PETITIONED WARRANT ARTICLES**

Registered voters in Rye may submit Petitioned Warrant Articles for the 2021 Warrant to the Select Board until the deadline of Tuesday, January 12, 2021. For more information, please call the Selectmen's Office at 603-964-5523 or by email at [selectmen@town.rye.nh.us](mailto:selectmen@town.rye.nh.us). Instructions are also posted on the Town Website: [www.town.rye.nh.us](http://www.town.rye.nh.us) on the Selectmen's Office page.

# Town of Rye Board Meetings

**Sunday      Monday      Tuesday      Wednesday      Thursday      Friday      Saturday**

Selectmen's meetings are held in the Rye Town Hall Courtroom (first floor), 10 Central Road. Other board meetings are also held at Rye Town Hall, 10 Central Road, unless otherwise noted. Because meeting schedules are subject to change, check the bulletin board at Town Hall or the Town Website [www.town.rye.nh.us](http://www.town.rye.nh.us) for up-to-date information.

## December 2020

		<b>1</b>	<b>2</b> 9:00 am Rye Water District 60 Sagamore Road 7:00 pm Zoning Board of Adjustment	<b>3</b> 3:30 pm Heritage Commission	<b>4</b>	<b>5</b>
<b>6</b>	<b>7</b> 3:00 pm Energy Committee  6:00 pm Recreation Commission	<b>8</b> 8:00 am Sewer Commission 6:00 pm Planning Board 6:30 pm Budget Committee Work Session School Budget	<b>9</b>	<b>10</b> 6:30 pm Budget Committee Work Session Town Budget 7:00 pm Conservation Commission	<b>11</b>	<b>12</b>
<b>13</b>	<b>14</b> 6:30 pm Select Board	<b>15</b> 5:00pm Mosquito Control	<b>16</b> 9:00 am Rye Water District Work Session 60 Sagamore Road	<b>17</b>	<b>18</b>	<b>19</b>
<b>20</b>	<b>21</b> First Day of Winter	<b>22</b>	<b>23</b>	<b>24</b>	<b>25</b> Christmas Day Town Offices Closed	<b>26</b>
<b>27</b>	<b>28</b> 6:30 pm Select Board	<b>29</b>	<b>30</b>	<b>31</b>		

## January 2021

					<b>1</b> New Year's Day Town offices Closed	<b>2</b>
<b>3</b>	<b>4</b> 3:00 pm Energy Committee 6:00 pm Recreation Commission	<b>5</b>	<b>6</b> 9:00am Rye Water District 60 Sagamore Road 7:00 pm Zoning Board of Adjustment	<b>7</b> 3:30 pm Heritage Commission	<b>8</b>	<b>9</b>
<b>10</b>	<b>11</b> 6:30 pm Select Board	<b>12</b> 8:00 am Sewer Commission 6:00 pm Planning Board	<b>13</b> 6:30 pm Public Hearing School Budget	<b>14</b> 6:30 pm Public Hearing Town Budget 7:00 pm Conservation Commission	<b>15</b>	<b>16</b>
<b>17</b>	<b>18</b> MLK Civil Rights Day Town Offices Closed	<b>19</b>	<b>20</b> 9:00 am Rye Water District Work Session 60 Sagamore Road	<b>21</b>	<b>22</b>	<b>23</b>
<b>24</b>	<b>25</b> 6:30 pm Select Board	<b>26</b>	<b>27</b>	<b>28</b>	<b>29</b>	<b>30</b> 9:00 am DELIBERATIVE SESSION Jr. High School

## February 2021

<b>31</b>	<b>February 2021</b>					
	<b>1</b> 3:00 pm Energy Committee 6:00 pm Recreation Commission	<b>2</b> 4:00 pm Precincts – Work Session & Public Hearing	<b>3</b> 9:00am Rye Water District 60 Sagamore Road 7:00 pm Zoning Board of Adjustment	<b>4</b> 6:30 pm Heritage Commission	<b>5</b>	<b>6</b>
<b>7</b>	<b>8</b> 6:30 pm Select Board	<b>9</b> 8:00 am Sewer Commission 6:00 pm Planning Board	<b>10</b>	<b>11</b> 7:00 pm Conservation Commission	<b>12</b>	<b>13</b>
<b>14</b>	<b>15</b> President's Day Town Offices Closed	<b>16</b>	<b>17</b> 9:00 am Rye Water District Work Session 60 Sagamore Road	<b>18</b>	<b>19</b>	<b>20</b>
<b>21</b>	<b>22</b> 6:30 pm Select Board	<b>23</b>	<b>24</b>	<b>25</b>	<b>26</b>	<b>27</b>
<b>28</b>						

Library Trustees, first Thursday every month  
5:30 pm at the Library

Additional Civic Meetings: Rye Lions Club, First Wednesday every month, 7 pm at the Rye Library  
Friends of the Library, second Tuesday every month, 7pm at the Library



## Rye Firefighter's Toy Bank

Summer is over and the holiday season is on its way...

This is the time that the Rye Firefighters start to plan for the families of the Rye Community and the surrounding Seacoast Area that will be unable to share in the joys of the season. This is the 15th year that the Rye Firefighters have been able to participate in the Seacoast Area Firefighter Toy Bank and we greatly appreciate all of the support that our local community has offered to fellow residents. The many donations of toys and financial contributions have helped to make the season a wonderful time for various families who would be unable to celebrate on their own. This is why we once again must ask for your help in preparing for this season. We will be accepting any donations that could be offered from November 1<sup>st</sup> until December 21<sup>st</sup>.

Here is how you can assist:

- ◆ Donate new, unwrapped toys for ages from newborn to 17 years old. Some ideas for donations are toys, crafts, games, dolls, inflatable sleds, footballs and basketballs. We are always looking for ideas for the 11-17 age group.
- ◆ Donate gift cards for local merchants to aid in purchasing items such as clothing and toys.
- ◆ Donate financial contributions to assist in making certain wishes come true. Donations should be made to the Rye Firefighter Toy Bank.
- ◆ Please drop off or mail any of your donations to the Rye Fire Station located at 555 Washington Road.
- ◆ Toy Drop-off Locations will be located at: Rye Fire Station, Mainly Tubs, Lazy Bird Cafe, Saint Theresa Church, Rye Town Hall, Rye Junior High, Rye Elementary, Rye Library, Rye Congregational Church, Seaport Fish, Atlantic Grill and Rye Country Day School.

If you or someone you know could use some assistance for the holidays please contact the number below.

Please feel free to contact FF Charles Gallant or FF John Klanchesser at (603) 964-6411

Thank You for Your Support

---

Town of Rye  
RYE, NH 03870

PRSR STD ECRWSS US Postage Paid Rye, NH Permit #10
--

**POSTAL CUSTOMER**  
**RYE, NH 03870**